

Single-part clamping ring

for connecting pipes with a wall thickness of 1mm including Egobon sealing insert



Material

1.0038 electrically galvanized
1.4301 stainless steel

Profile



up to DN 224 from DN 250

Seal



up to DN 224 from DN 250

Egobon seal inserted in profile

DN nominal width	Inner diameter A	Screw DIN912	Material thickness	Weight
80	86	M6 x 60	0,75	0,078
90	96	M6 x 60	0,75	0,081
100	106	M6 x 60	0,75	0,084
112	118	M6 x 60	0,75	0,087
120	126	M6 x 60	0,75	0,090
125	131	M6 x 60	0,75	0,091
140	146	M6 x 60	0,75	0,095
150	156	M6 x 60	0,75	0,098
160	166	M6 x 60	0,75	0,101
175	181	M6 x 60	0,75	0,105
180	186	M6 x 60	0,75	0,106
200	206	M6 x 60	0,75	0,112
224	230	M6 x 60	0,75	0,119
250	256	M8 x 60	1,5	0,285
280	286	M8 x 60	1,5	0,308
300	306	M8 x 60	1,5	0,323
315	321	M8 x 60	1,5	0,334
350	356	M8 x 60	1,5	0,360
355	361	M8 x 60	1,5	0,364
400	406	M8 x 60	1,5	0,398
450	456	M8 x 60	1,5	0,435
500	506	M8 x 60	1,5	0,473
550	556	M8 x 60	1,5	0,510
560	566	M8 x 60	1,5	0,518
600	606	M8 x 60	1,5	0,548
630	636	M8 x 60	1,5	0,570

Versions in
steel 1.0038,
electrically galvanized
stainless steel 1.4301

i The single-part ESKATE clamping ring with integrated sealing insert is a classic and affordable pipe connection for light 1 mm pipe systems.

Note: The gasket can remain in the clamping ring during assembly and does not need to be removed.

i Very short lead times due to all year round availability from stock. Custom and non-standard factory sizes available on request

Minimum order value: Net goods value of 40.00 euros. The prices do not include VAT, packaging and forwarding. All dimensions in mm. All weights in kg. Subject to errors and alterations.

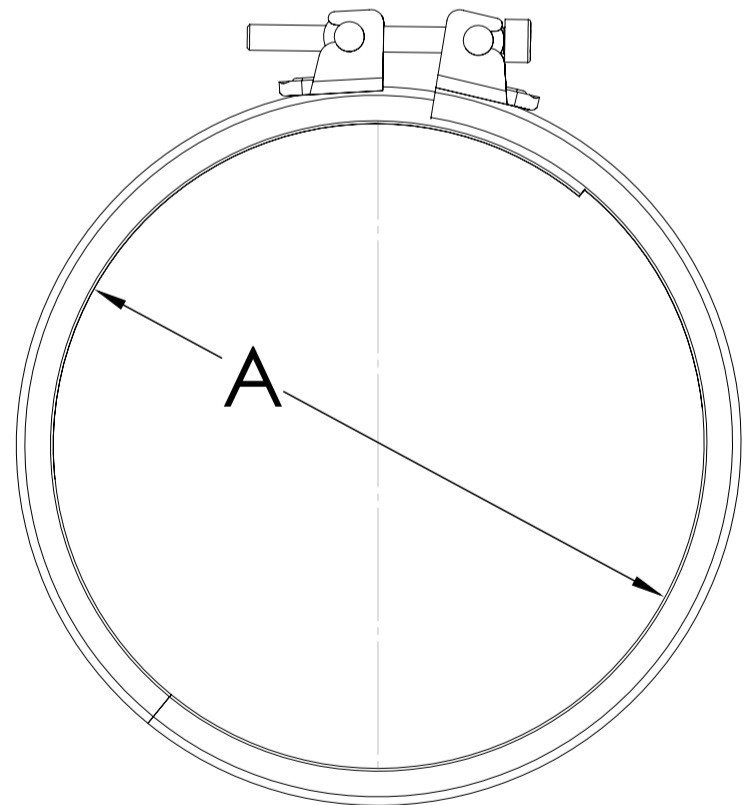

We would be pleased to advise you on your individual terms and designs. Just give us a call.
✉ info@eskate.de ☎ +49 5734 66 66 6